

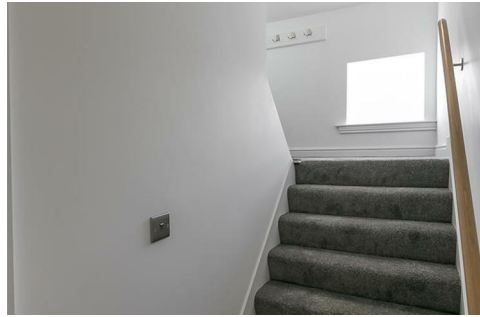

This stylish second floor apartment, forming part of a sensitive conversion, is ideally situated on Clayton Road in the heart of the Brandling Village Conservation Area, Jesmond. Clayton Road, close to Jesmond Metro station, the shops, restaurants and cafés of Jesmond and as well as a short walk to Newcastle City Centre itself.

With a modern finish and well presented throughout the accommodation, accessed via its own front door briefly comprises: private staircase to; entrance hall; lounge, with dormer window; kitchen with integrated appliances; bedroom with Velux window; shower room WC, fully tiled with step in shower. With electric heating system, double glazed windows and offered to the market on a furnished basis. With no onward chain, a perfect purchase opportunity for a couple or single professional.

Stylish Conversion Apartment Second Floor | 490 Sq ft (45.6m²) | Lounge | Kitchen | One Double Bedroom | Shower Room | Shared Rear Courtyard | Brandling Village Conservation Area | Excellent Location | No Onward Chain | Leasehold with 120 Years Remaining | Service Charge £1,500 Per Annum | Council Tax Band: A | EPC Rating: E



1ST FLOOR
63 sq.ft. (5.8 sq.m.) approx.

2ND FLOOR
428 sq.ft. (39.7 sq.m.) approx.

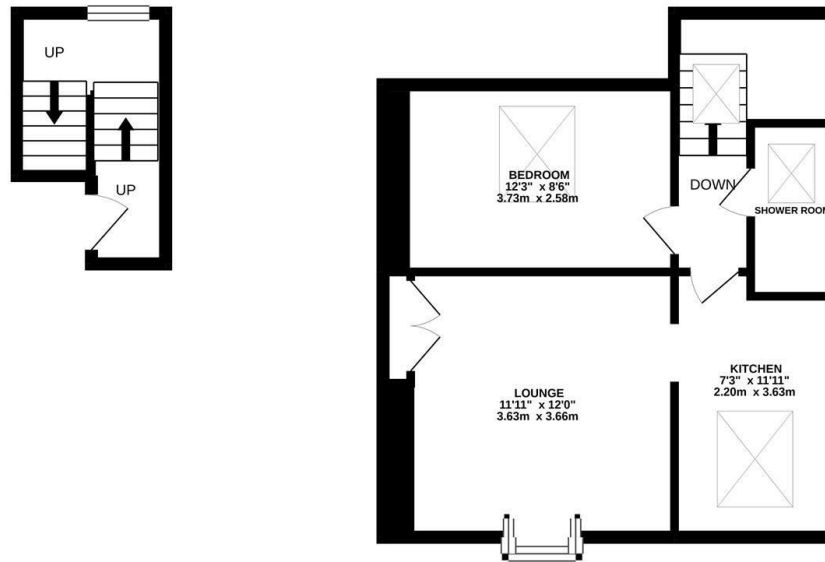

TOTAL FLOOR AREA : 490 sq.ft. (45.6 sq.m.) approx.

Whilst every attempt has been made to ensure the accuracy of the floorplan contained here, measurements of doors, windows, rooms and any other items are approximate and no responsibility is taken for any error, omission or mis-statement. This plan is for illustrative purposes only and should be used as such by any prospective purchaser. The services, systems and appliances shown have not been tested and no guarantee as to their operability or efficiency can be given.
Made with Mentrax ©2020



Offers Over £145,000

IMPORTANT NOTE: These particulars and the descriptions and measurements herein do not constitute representation and whilst every effort has been made to ensure accuracy, this cannot be guaranteed.

